

ITEM NO.	AMT.	DESCRIPTION	ITEM NO.	AMT.	DESCRIPTION	ITEM NO.	AMT.	DESCRIPTION
1	1	HZ**01-* / WORK ROD	11	3	"O-RING" #568-***-90	21	1	"O-RING" #NBR-***
2	1	E**03 / ROD BEARING CARTRIDGE	12	1	"BLUE" PISTON SEAL	22	1	THE PISTON SEAL W/ O-RING
3	1	E**04 / RECTANGULAR WORK HEAD	13	1	HZS**15-*/** / H.P. ROD	23	1	E**62 / CAP
4	1	HZS**06-* / WORK PISTON	14	1	E**16 / HIGH PRESSURE PISTON	24	8	*** HEX LOCK NUT, GRADE 8
5	1	HZS**05-* / WORK SECTION TUBE	15	1	ROD WIPER	25	4	HZS**60-**/ WK SECTION THE RODS
6	2	BP-** / PISTON BUMPER	16	1	"O-RING" #568-***-70	26	1	E**59 / CAP
7	1	"BLUE" U-CUP ROD SEAL	17	1	U-CUP	27	1	E**64 / CAP
8	1	HZ**10 / VALVE BLOCK	18	3	"O-RING" #568-***-70	28	4	HZS**63-**/ BOOSTER THE RODS
9	1	HZS**61-* / H.P. EXTENSION TUBE	19	1	"BLUE" U-CUP PISTON SEAL	29	2	E**BRK / BOOSTER MOUNT BRACKET
10	1	HZS**14-** / H.P. SECTION TUBE	20	1	WEAR BAND	30		

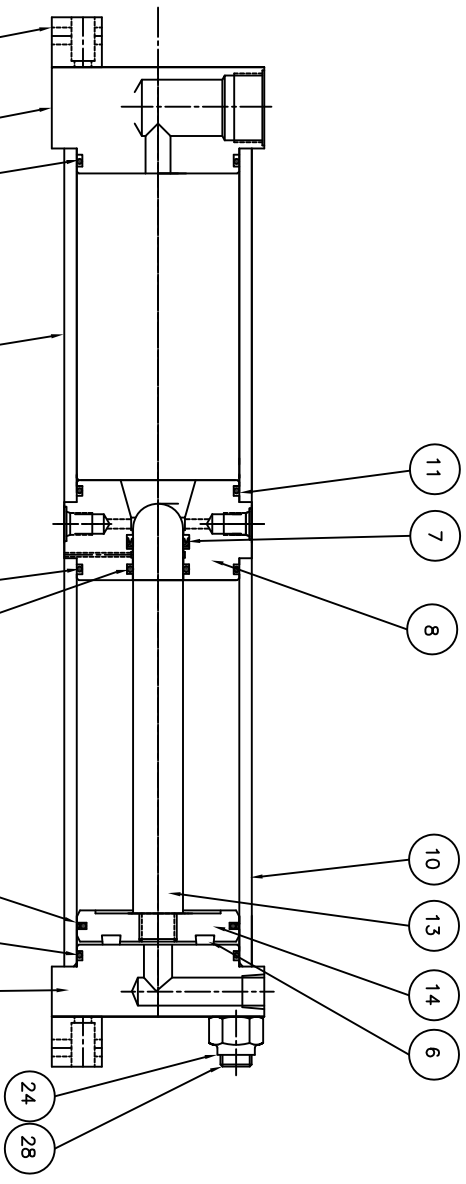
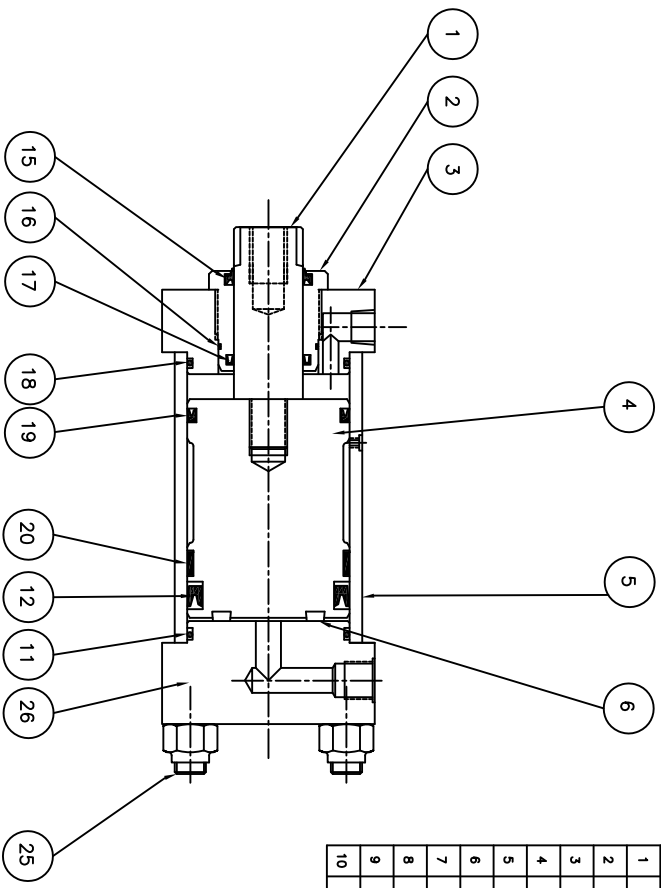

HYPERCYL TONNAGE	THE ROD TORQUE FOOT POUNDS	THE ROD THREAD
1-TON	22 FT-LBS	3/8"-24
2-TON	22 FT-LBS	3/8"-24
4-TON	80 FT-LBS	5/8"-18
8-TON	80 FT-LBS	5/8"-18
10/15/20-TON	120 FT-LBS	3/4"-16
30/40-TON	400 FT-LBS	1.00"-14
50/60-TON	650 FT-LBS	1.25"-12
75/90/100-TON	750 FT-LBS	1.25"-12
200-TON	1000 FT-LBS	1.25"-12

HYPERCYL Artes Engineering Company, Inc.
 130 Artes Drive, Dundee, NJ 08833
 TEL: 734 529-8855 FAX: 734 529-8844

TOLERANCE UNLESS OTHERWISE SPECIFIED
 HYPERSERIES: 0.015
 THEE PACT: 0.004, 0.005
 BREAK ALL UNLESS OTHERWISE SHOWN OTHERWISE

DESIGNER: MAB DATE: 3/31/16
 CHECKED: [] SCALE: []

DESCRIPTION: "HZS" SERIES HYPERCYL CYLINDER
 WPTL: SEE BILL OF MATERIAL
 DMC: HZS-**-COMPONENT CALLOUT